

**ISO-Nr. :** **10 B-1**  
**15,875 x 9,65 mm**  
**5/8" x 3/8"**

Rollen Ø: 10,16 mm  
 Werkstoff: Stahl C45, gehärtete Zähne HRC 50  
 Beschreibung: Bohrung: Toleranz H7; Rauheit: Ra 1,6;  
 Nut: nach DIN 6885 / BS 4235  
 ausgerichtet auf Mitte Zahn;  
 2 Stellschraubengewinde

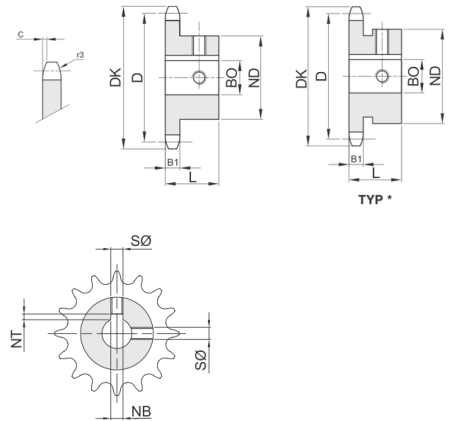

### Übersichtsmatrix Bohrungsdurchmesser > Zähnezahl

5/8" x 3/8" - 15,875 x 9,65 mm Rollen Ø=10,16 mm   B1=9,1 mm   C=1,6 mm   r3 = 16°					mögliche Bohrungsdurchmesser B0 (mm)														
ZZ Zähne	DK (mm)	D (mm)	ND (mm)	L (mm)	15	16	18	19	20	22	24	25	28	30	32	35	38	40	42
10	58,3	51,37	35-42	25	✓	✓	✓	✓	✓		✓								
11	63,2	56,34	37-47	30	✓	✓	✓	✓	✓		✓	✓							
12	68,2	61,34	42-55	30	✓	✓	✓	✓	✓	✓	✓	✓	✓	✓	✓				
13	73,2	66,32	47-57	30	✓	✓	✓	✓	✓	✓	✓	✓	✓	✓	✓				
14	78,2	71,34	52	30	✓	✓	✓	✓	✓	✓	✓	✓	✓	✓	✓				
15	83,2	76,36	57	30				✓	✓	✓	✓	✓	✓	✓	✓	✓			
16	88,3	81,37	60	30				✓	✓	✓	✓	✓	✓	✓	✓	✓	✓		
17	93,3	86,39	60	30				✓	✓	✓	✓	✓	✓	✓	✓	✓	✓	✓	
18	98,3	91,42	60-70	30				✓	✓	✓	✓	✓	✓	✓	✓	✓	✓	✓	✓
19	103,3	96,45	60-70	30				✓	✓	✓	✓	✓	✓	✓	✓	✓	✓	✓	✓
20	108,4	101,49	65-75	30				✓	✓	✓	✓	✓	✓	✓	✓	✓	✓	✓	✓
21	113,4	106,52	65-75	30				✓	✓	✓	✓	✓	✓	✓	✓	✓	✓	✓	✓
22	118,4	111,55	65-80	30				✓	✓	✓	✓	✓	✓	✓	✓	✓	✓	✓	✓
23	123,5	116,58	65-80	30				✓	✓	✓	✓	✓	✓	✓	✓	✓	✓	✓	✓
24	128,5	121,62	65-80	30				✓	✓	✓	✓	✓	✓	✓	✓	✓	✓	✓	✓
25	133,6	126,66	65-80	30				✓	✓	✓	✓	✓	✓	✓	✓	✓	✓	✓	✓